

# LED RF Controller Mono - User Manual



Controller: LC-002-012



Receiver: LC-002-010

## 1. Product Description

The RF Controller Mono is a wall rotary RF dimer with 256 levels logarithmic dimming from 1-100%. simple and friendly use for dimming and switching ON/OFF for 1 zone.

## 2. Specification

### 2.1. Controller LC-002-012:

input power: 3VDC Cr2032 & Cr2025 Battery,

PWM frequency: 434MHZ / 868 MHZ

### 2.2. Receiver LC-002-010:

12-24VDC input power, 4 channels x 5A, constant voltage, 4 channels x (60-120)W

## 3. Installation

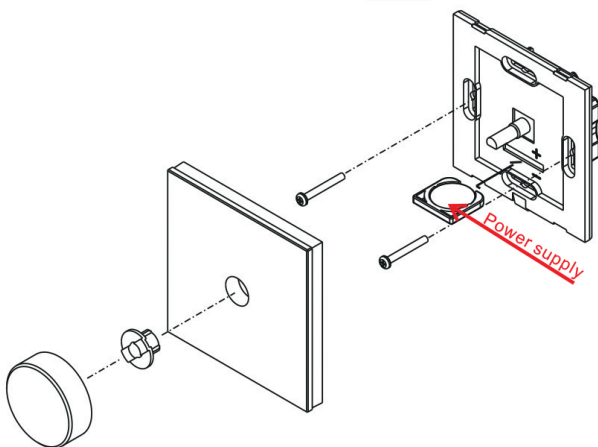

## 4. Wiring Diagram

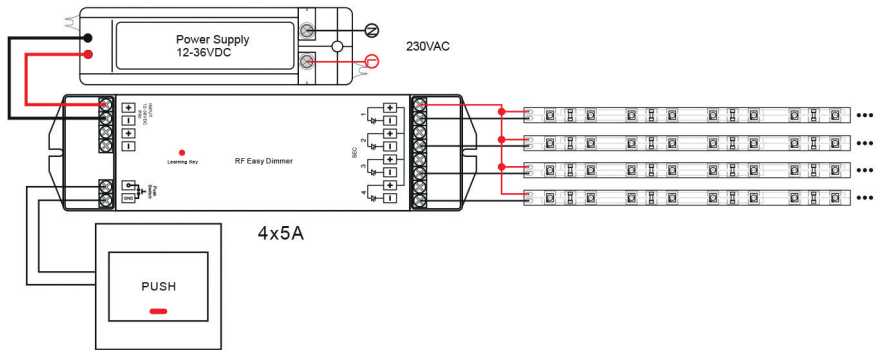

## 5. Instructions

Pls connect as per point 4. Connection Diagram the LED lights on the receiver, insert the battery in the receiver and then connect controller and receiver.

**5.1.** Press the Learning Key-Button ● on the receiver, and thereafter press the rotary button ● on the controller. If the LED light flashes once, you have successfully completed the pairing. Repeat the process with the other receivers, if you need them also. You can connect any number of recipients.

**5.2.** One short press on the rotary button ● to turn the unit ON and OFF.  
Adjust the brightness using the rotary button and turn from left to right for 1-100%  
Adjust the brightness using the rotary button and turn from right to left for 100-1%

### Memory (Address) delete:

If you want to erase the memory of the receiver, hold the learning key button for 10 seconds, while the receiver is powered. Through the flash lighting of the LEDs the deletion of the memory will be confirmed: The receiver is thus set back to factory settings and loses its addressing.